

CERTIFIED LAND CORNER RECORDATION

DESCRIPTION OF CORNER EVIDENCE FOUND, AND ORIGINAL RECORD (If known)

Found U.S. Land Office bras-cap monument stamped $\frac{14}{\text{Wyo. 23}}$ Nebr T 14 N R 60 W

DESCRIPTION OF MONUMENT AND ACCESSORIES ESTABLISHED
TO PERPETUATE THE ORIGINAL LOCATION OF THIS CORNER:

Left monument as found.

Set $\frac{1}{2}$ " pipe in fence line to north and $\frac{1}{2}$ " pipe in fence line to west for witness corners.

SKETCH, WITH COURSE AND DISTANCE TO ADJACENT CORNER IF DETERMINED IN THIS SURVEY.
(May Sketch or Paste Reproduction on Reverse Side.)

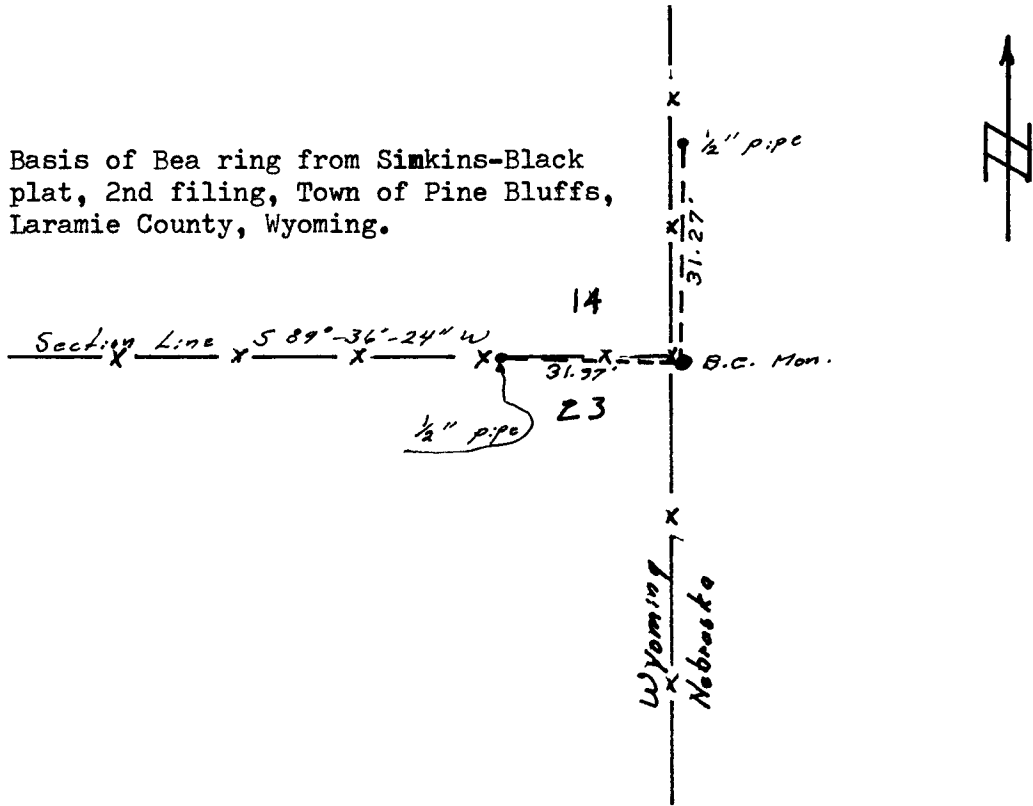

I, Robert C. Corbet certify that I have carefully performed or reviewed the work done on the diagrammed corner as reported on this recordation form and approve the same.

Robert C. Corbet
Signature of Surveyor

495
Registration No.

STATE OF WYOMING,
Office of Clerk and Recorder,
County of Laramie

This "corner record" was filed for record on the 6 day of January, 19 75, was noted on the cross-index plat and is assigned page No. _____, in book No. _____.

James C. Whitehead

County Official

Cross Index No. <u>N 19</u>	T. <u>14</u>	R. <u>60</u>	<u>6</u> Mer.
_____	T. _____	R. _____	Mer.
_____	T. _____	R. _____	Mer.
_____	T. _____	R. _____	Mer.
_____	T. _____	R. _____	Mer.
_____	T. _____	R. _____	Mer.
_____	T. _____	R. _____	Mer.

Photographed ✓
Indexed ~~SB~~ ✓
Posted ✓
Assessor ✓

The State of Wyoming } ss
County of Laramie

This instrument was filed for record
at 128 o'clock P M, on the
6 day of January
A. D. 19 75 and duly recorded in
Book _____ on page _____

James C. Mitchell

County Clerk & Ex-Officio Registrar of Deeds
By *JCM* _____